

Machinery and Plants for
Paper Industry
Water Treatment Systems

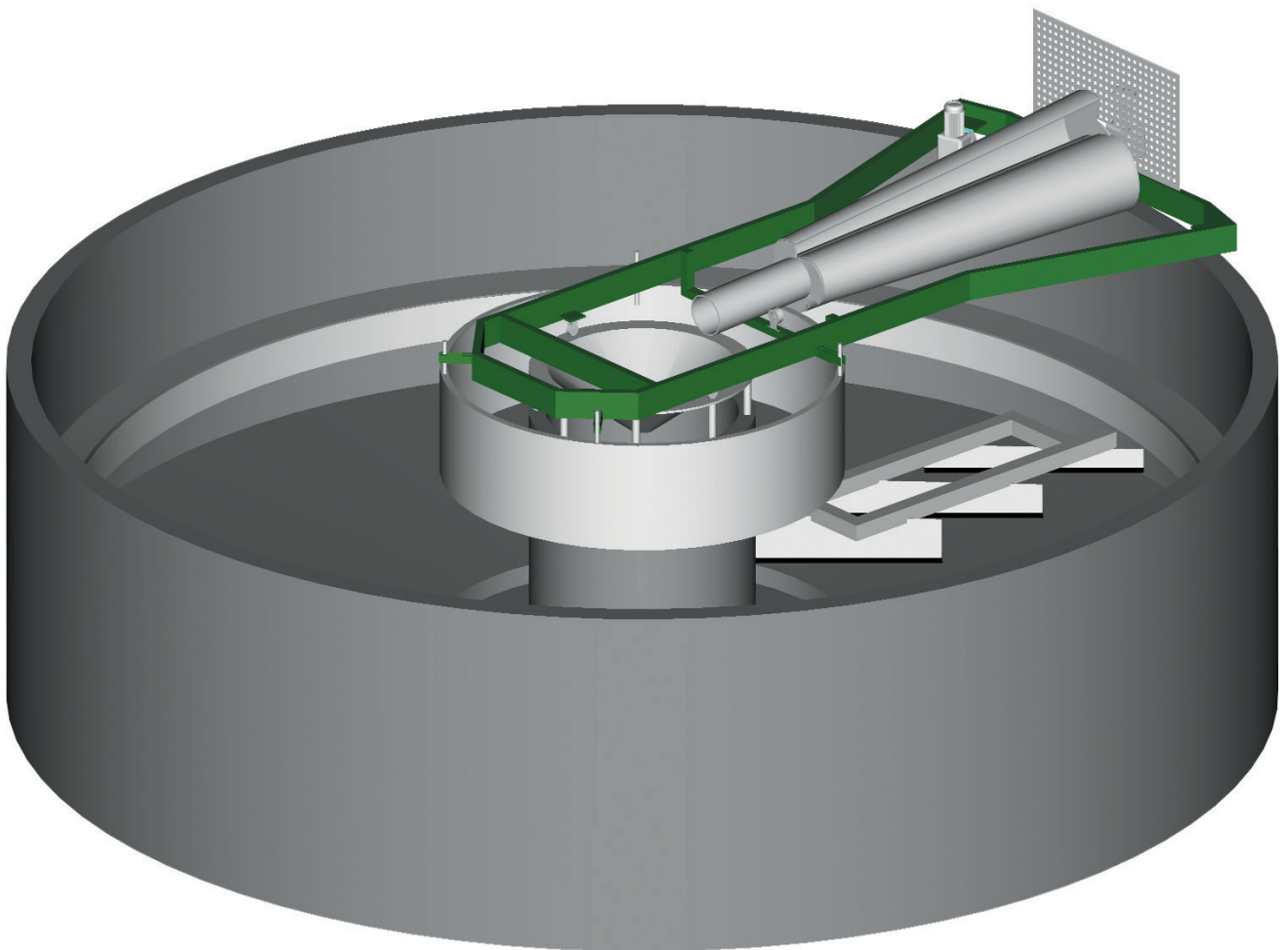

Sediflot CHS
Dissolved Air Settling - Flotation Unit

Sediflot CHS

Dissolved Air Settling - Flotation Unit

The Sediflot is an equipment that, by using the dissolved air flotation technology, is providing the solid – liquid separation. The floatation tank is circular shaped and can be manufactured in stainless steel, concrete or sidewalls in steel with concrete bottom. It features of a high water profile in order to allow both the flotation and sedimentation phases.

The flotation unit is achieving high performances in combination with an high efficiency pressurization system.

The process mode may be operational on partial or full flow of the raw water or recycling flow pressurisation of the clarified water. The mode is evaluated during the project phase.

The flotator is fed from the centre of the tank thus allowing a uniform and radial distribution of the water in the flotation surface.

A rotating skimmer installed on a movable bridge is removing the floated sludge from the surface, pouring it into a central tank from where the sludge is discharged by gravity. The optimal consistency of the sludge is obtained adjusting the tank water level by acting on the system made by level transmitter and modulant valve.

The clarified water is collected by an immersed manifold and conveyed out of the machine through a main collector where the modulant valve for level control is installed.

The settled particles are conveyed by a bottom scraper in a sump in from where they are discharged by an automatic timed valve. A lateral scraper is installed for the cleaning of the sidewalls of the tank. This is reducing the need to stop the machine operation for cleaning reasons.



Applications sectors:

- Municipal and Industrial Water Treatment Plant
- Biological sludge thickening
- Paper and Board Industry
- Oil Refinery
- Mining Industry
- Chemical and Pharmaceutical Industry
- Textile Industry and Tanneries
- Food and Beverage Industry
- Industrial Laundry
- Winery
- Dairy
- Abattoir
- Fish Industry
- Potable Water Plant

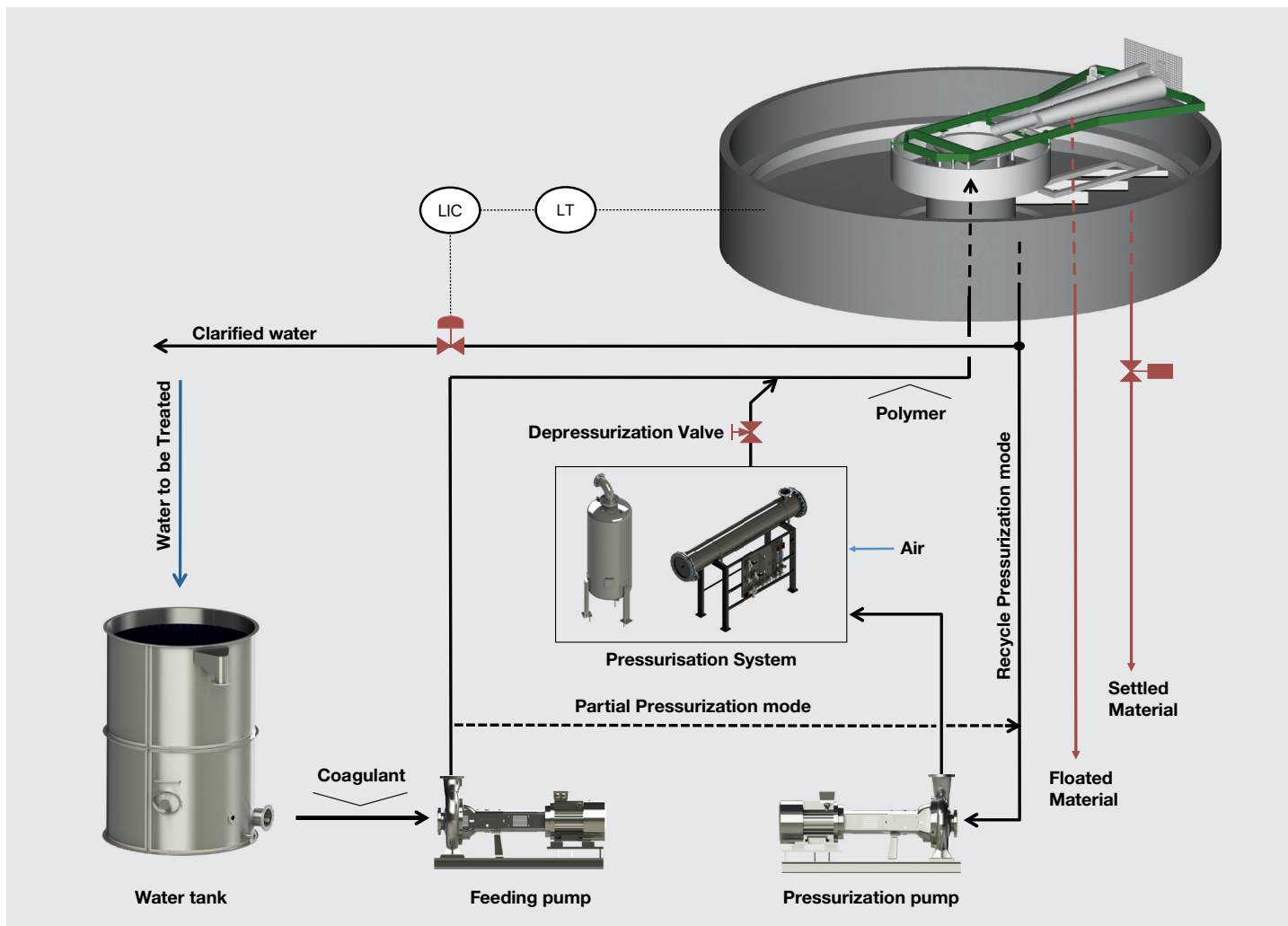

Model	Capacity m ³ /h	Overall Diameter mm	Tank Height mm	Overall Height mm
CHS 2400	20	2800	3000	3300
CHS 3200	38	3600	3000	3400
CHS 3900	56	4300	3000	3400
CHS 4500	75	4900	3000	3500
CHS 5500	112	5900	3000	3530
CHS 6100	137	6600	3000	3610
CHS 6700	165	7200	3000	3630
CHS 7200	190	7700	3000	3650
CHS 8100	240	8600	3000	3750
CHS 9000	300	9600	3000	3870
CHS 10000	368	10600	3000	3890
CHS 11000	447	11600	3000	3910
CHS 12200	547	12800	3000	3960
CHS 13400	662	14000	3000	3995
CHS 14800	806	15400	3000	4085
CHS 16800	1037	17400	3000	4215
CHS 18900	1250	19500	3000	4300
CHS 21300	1562	21900	3000	4300

S.T. MACCHINE SpA
via Calcara, 1
36030 Monte di Malo (VI) Italy

tel +39 0445 602688
fax +39 0445 605452

www.stmacchine.it
info@stmacchine.it

